



**PRO5000**

# ***CAUTION***

***READ INSTRUCTIONS BEFORE USE***

**Always wear protective gear when using this equipment.**

**THE FOUR CORD BALL SYSTEM IS DESIGNED FOR QUICK BALL RESET AND GETTING MORE REPS IN A SHORT PERIOD OF TIME.**

**FOR BALL PLACEMENT DRILLS SHOWING THE TRUE FLIGHT OF THE BALL REMOVE THE BOTTOM BUNGEE CORD AND CONVERT IT TO A 3 CORD BALL SYSTEM.**

# Solohitter PRO5000 PARTS VIEW

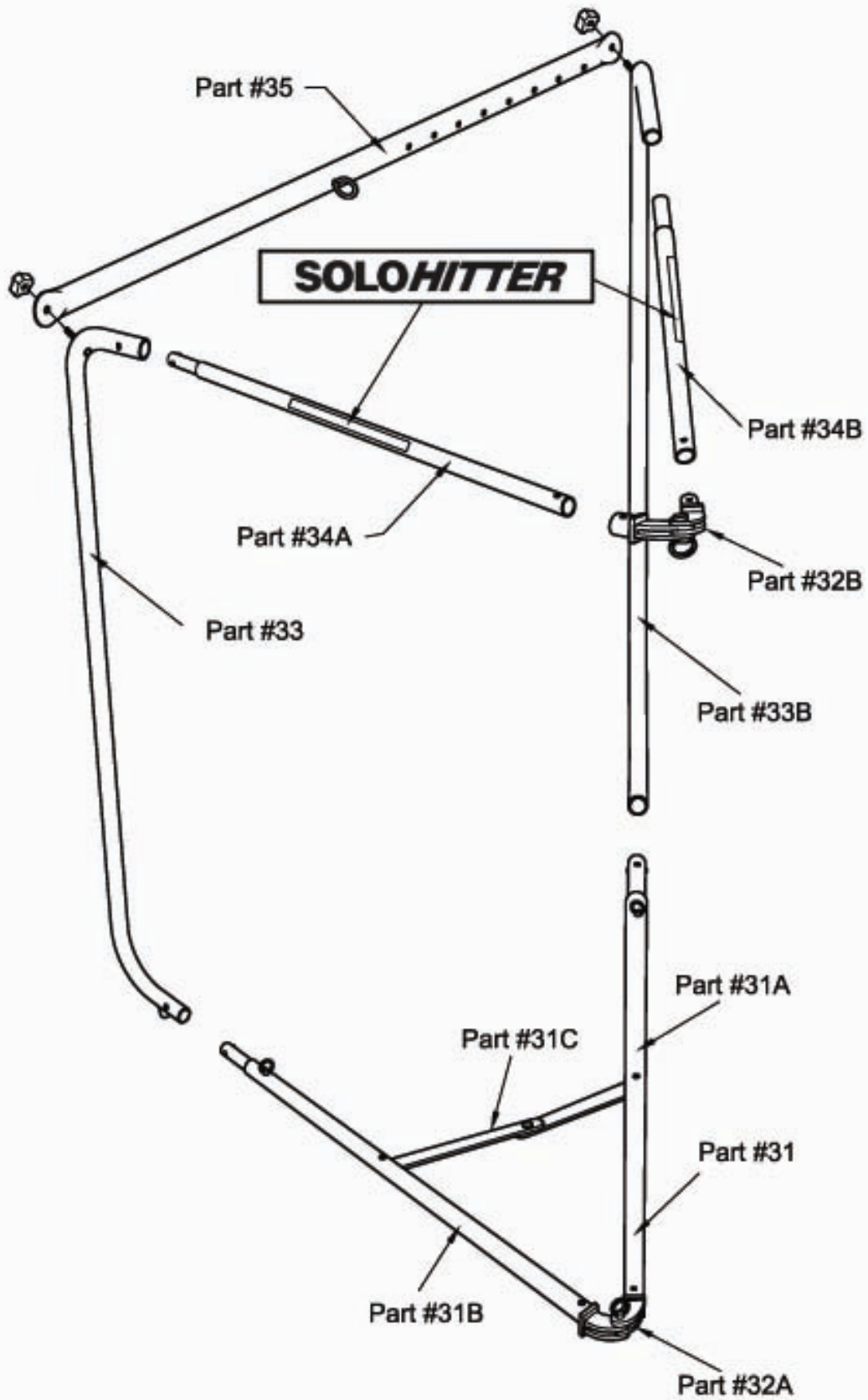

## SOLOHITTER PRO5000 Assembly Instructions – BOTTOM SECTION

### Fig. 1 – Step 1

- Place bottom rail frame set (Part #31) with rubber feet down
- Spread Solohitter frame completely open until bottom, flat articulated brace, (#31C) on (Part #31) is locked in place. Slide bracket lock into locked position.
- Take U shaped post (part #33 and #33B) with rubber feet down slide into bottom rail set. Make sure the push buttons pop up into the hole.

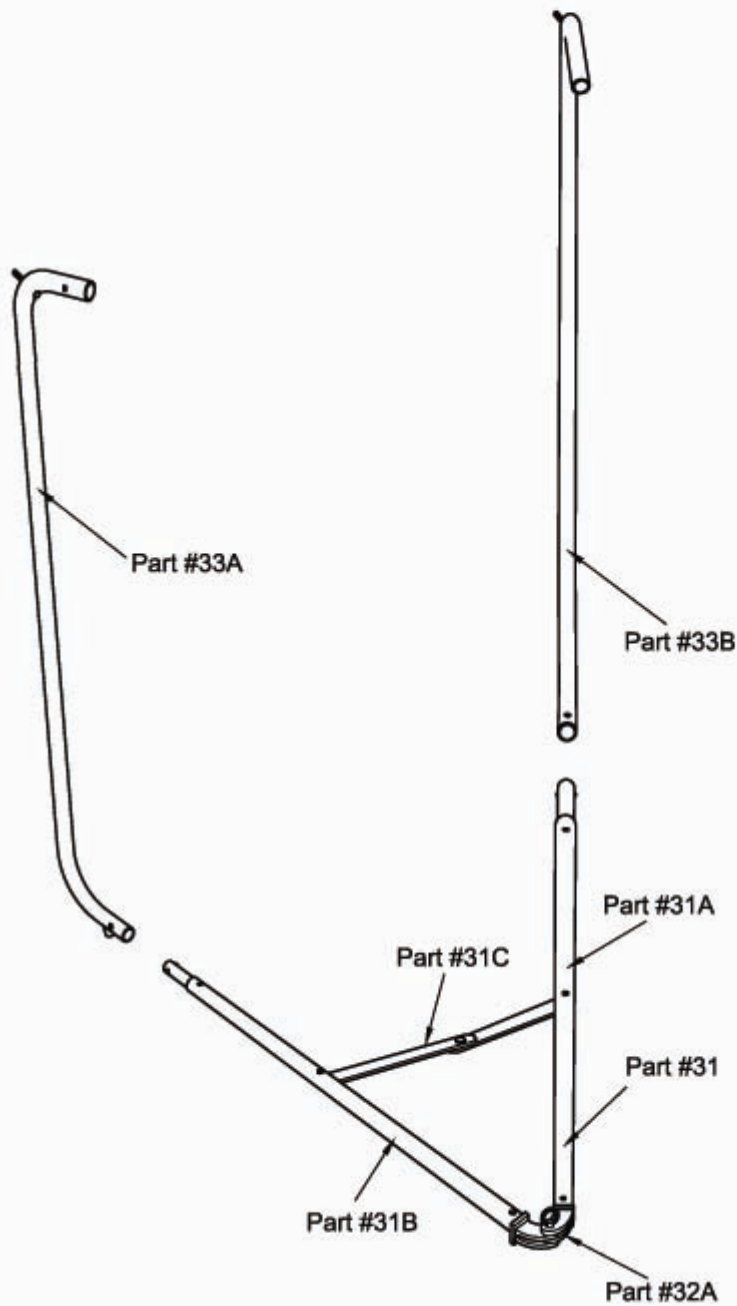
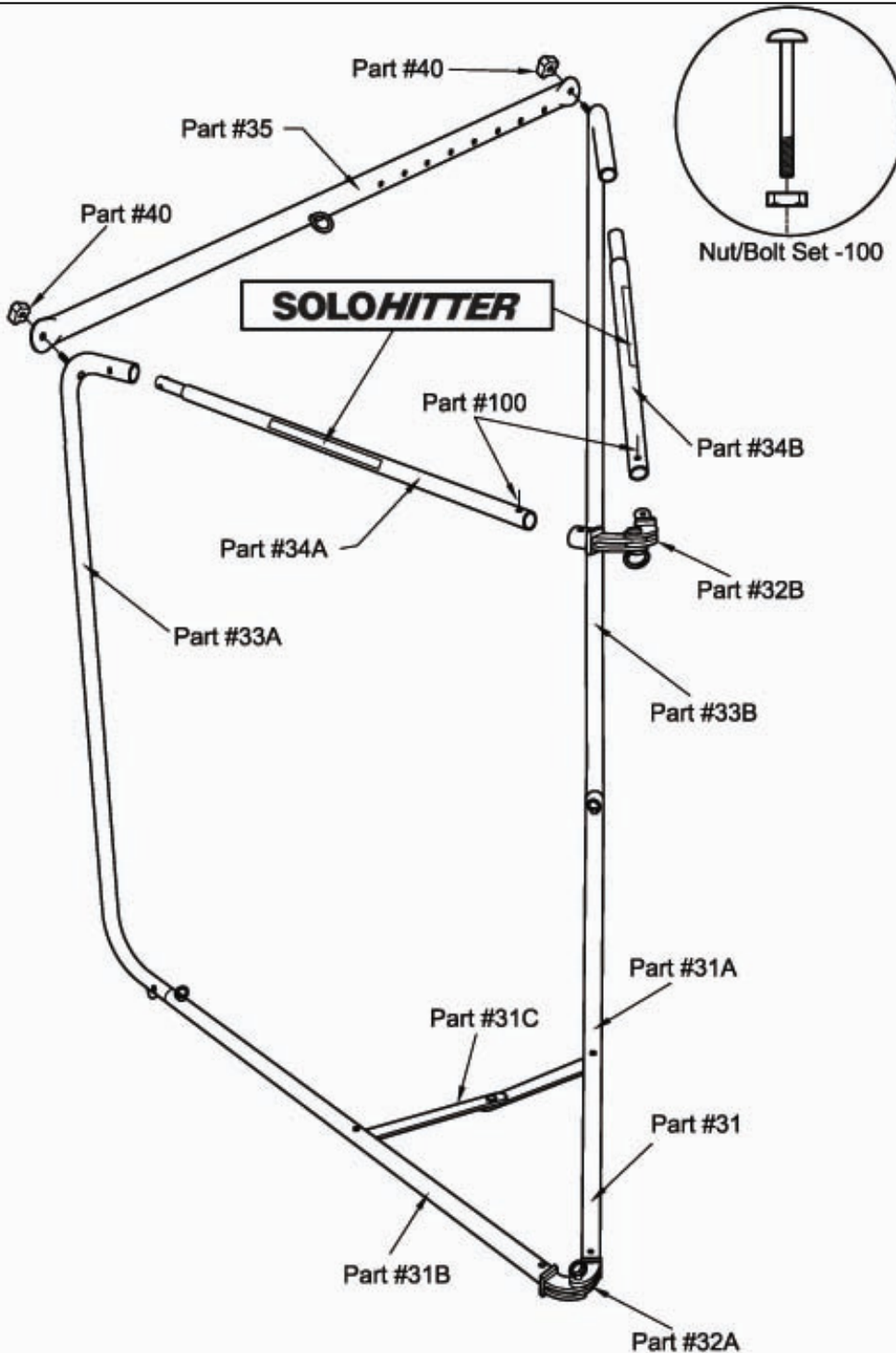

**FIGURE 1**

## SOLOHITTER PRO5000 Assembly Instructions - TOP SECTION

### Fig.2 - Step 2

- Position and insert top rails (Part #34A and #34B) into the top of the U shaped vertical rails (Part's #33 &33B) as shown. Make sure the push buttons pop up into the holes.
- Insert hinge (Part #32B) into the top rails as shown( If the fit is tight lightly tap into place) Secure and tighten hinge to rails with the provided nut/bolt set.
- Attach Back bar with holes facing forward and to the right. Securely tighten with provided plastic knobs.

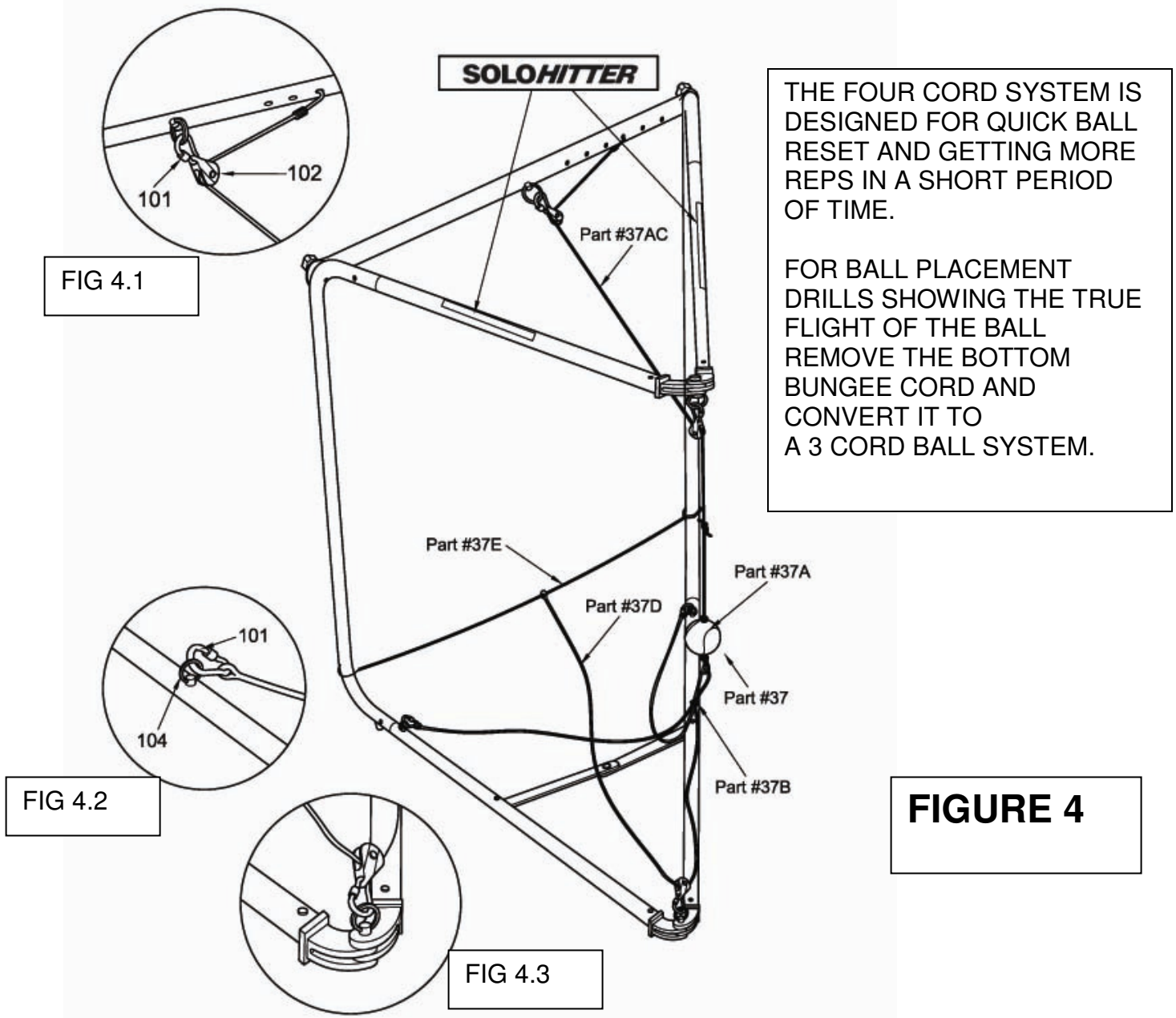

**FIGURE 2**



## SOLOHITTER PRO5000 Assembly Instructions – BALL ASSEMBLY

- Install ball assembly (Part # 37). NOTE: **Use ball assembly with attached pulleys**
- First, on the front top hinge cylinder eyebolt ring attach one pulley (Part # 102), with quick clip (#101). Next on the rear back brace cylinder eyebolt ring, attach one pulley with quick clip Fig 4.1, and hook bungee (Part # 37AC) to holes in rear brace. Attach the third pulley to the bottom hinge as shown in Fig 4.3
- Attach bottom safety cords (Part # 37B) to bottom rails as shown Fig 4.2.
- Attach bungee (Part #37E) to frame as shown.  
When assembled adjust for desired ball height.
- **CAUTION:** Adjust bungee (Part #37D) until there is a slight tension on the bungee, once adjusted **tie a secure knot**. Re- adjust as needed when ball height is changed.



## SOLOHITTER PRO5000 FOLDING INSTRUCTIONS

This Unit's hinged system is designed for easy folding and storage.

- First remove the net and baseball assembly.
- Second remove the back bar
- Place back bar knobs back onto bolts.
- NOTE: Fold bottom brace (31C) first and then fold the unit together.

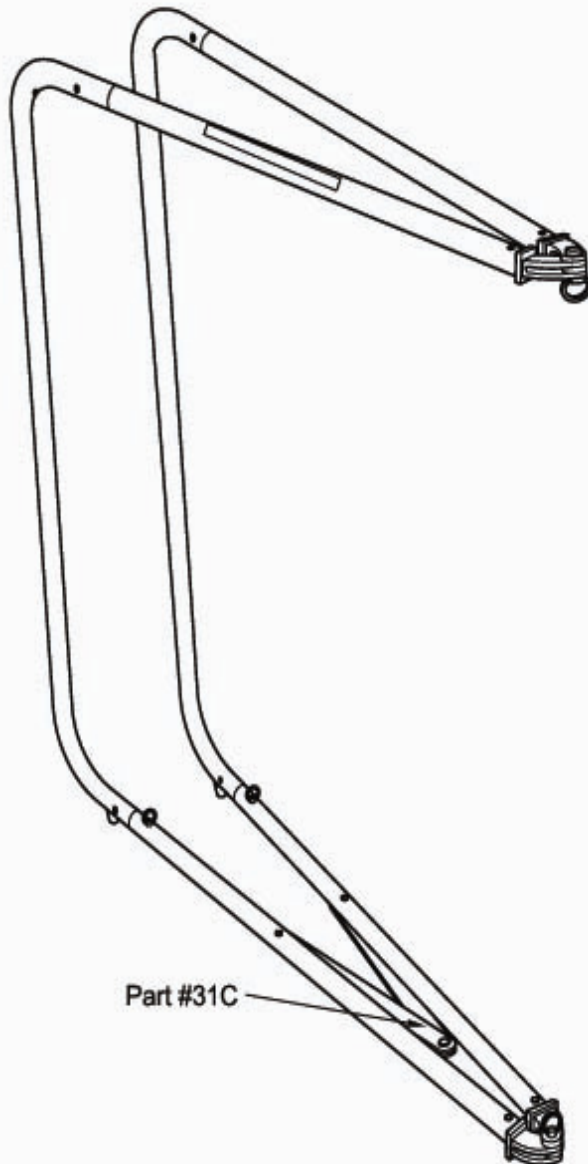

**FIGURE 5**

## **SOLOHITTER PRO5000**

### **SAFETY FIRST**

#### **BEFORE ANY SWINGS CAN BE TAKEN ON THE SOLOHITTER**

- ✓ MAKE SURE THE HOOK AT THE END OF THE BUNGEE CORD IS INSERTED IN ONE OF THE PIN- HOLES ON THE TOP LATERAL BRACE.
- ✓ MAKE SURE BOTH SAFETY LINES ARE ATTACHED TO THE SPLIT RINGS USING THE QUICK CLIPS AT THE END OF EACH CORD LINE AND TO THE SOLOHITTER FRAME.
- ✓ CHECK ALL KNOT CONNECTIONS AND BUNGEE TO CORD CONNECTIONS MAKE SURE THEY ARE TIGHT AND SECURE.

#### **PRO5000**

**ALWAYS WEAR PROTECTIVE SAFETY GEAR WHEN USING THIS EQUIPMENT.**  
**A BATTER MUST WEAR A BATTING HELMET WITH FACE GUARD WHEN USING THE SOLOHITTER.**

**NEVER STAND NEAR THE FRAMEWORK OF THE SOLOHITTER AT ANY TIME.**  
**SPECTATORS MUST STAND AT LEAST 20 FEET AWAY FROM THE SOLOHITTER WHEN THE EQUIPMENT IS IN USE.**

**NEVER HANG OR SWING FROM THE SOLOHITTER FRAMEWORK AT ANYTIME.**  
**THE FRAME WORK WAS NOT DESIGNED TO HOLD THE WEIGHT OF A PERSON.**

#### **MAINTENANCE:**

Periodically check the baseball or softball for signs of wear. Check the ball, elastic cord and safety lines for wear. Make sure elastic cord and safety lines are firmly in place and hooked to the Solohitter. This is very important! If your equipment is outside for an extended period of time bring your ball assembly inside to protect from sun and winter harm. Keep pets away from chewing on safety cords.

If your ball assembly is worn

**re-order assemblies and Parts at 1-800-875-3355 or at Solohitter.com**

**MODEL PRO5000**

**SOLO SPORTS INC. 105 Copperwood Way, Suite G, Oceanside, CA 92054**